



Southern Lehigh School District Hopewell Elementary School



PHASING PLAN

Phase 1: New Building Construction

Start: June 1, 2015

Substantial Completion: August 1, 2016

WORK COMPLETED

Phase 1 – New Building Construction work consisting of:

Site Work

- Complete installation of underground sanitary main piping including core drilling under West Hopewell Road into existing sanitary manhole to make final pipe connection.
- Storm Water Infiltration Area 33: 60% complete
- Installation of 2B stone on grade for Area A: 90% complete.

General Contractor

- Building layout completed. Excavation and placement of concrete footings completed for Building Areas A, B & C.
- Concrete slab on grade completed for Area A: 50% complete.
- Concrete slab on grade for Areas B and C: 100% complete.
- Construction of reinforced CMU walls for gymnasium: 90% completed.
- Cold formed metal Stud wall framing for Areas B and C: 85% complete.
- Setting of roof trusses: 10% complete.

WORK PROJECTED FOR NOVEMBER 2015

Site Work

- Finish installation of underground storm-water Infiltration Area 33.
- Complete install of 2B stone for slab on grade in Area A.
- Start installation of underground storm piping and structures.

General Contractor

- Complete concrete slab-on-grade in Area A.
- Construction of cold-formed metal structural framing for interior & exterior bearing walls in Areas A, B, and C.
- Erect structural steel roof trusses in Areas B & C.
- Finish stud framing for Areas A, B, and C.
- Begin laying brick around Gym area.

WORK COMPLETED (cont'd)**Plumbing Contractor**

- Complete underground sanitary main and sanitary grease drain piping in Area A.

Electrical Contractor

- Completed under-ground electrical feeder conduit install in Areas A, B, and C: 90% complete.
- Installation of under-ground branch conduit in Areas A, B, and C: 80% complete.
- Electrical rough-in within CMU gymnasium walls 75% completed.
- Completed the electrical vault and transformer installation.

Mechanical Contractor

- Drilling of geothermal wells proceeding, 15% completed, including installation of loop casing and poly supply & return piping.

WORK PROJECTED FOR NOVEMBER 2015 (cont'd)**Plumbing Contractor**

- Layout and installation of toilet room carriers in Areas B & C.

Electrical Contractor

- Continue in-wall electrical rough-in in Area A.
- Complete underground feeder conduit installation in Area A, including feeder electrical duct bank.
- Begin primary electrical duct bank work feeding into the building.

Mechanical Contractor

- Continue drilling of geothermal wells, including installation of casing and poly supply & return piping.
- Coordination of BIM model used with other Primes to insure no spatial conflicts.

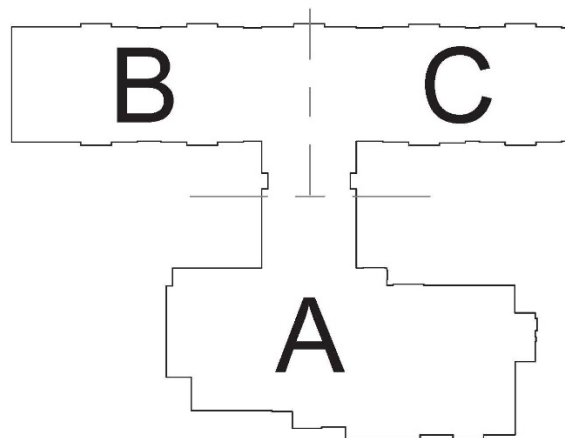
Building Layout

Area A: Administration, Gymnasium, Music, Cafeteria, Mechanical Room, Media Center

Area B: 2nd & 3rd Grade Classrooms, Collaboration Center

Area C: Kindergarten and 1st Grade Classrooms, Art Room



Payment Summary

General Construction - Lobar

Application #	Period Ending	Date Submitted	Net Amt for Payment	Cumulative Total	Total % Billed
1	07/31/15	07/28/15	\$ 253,564.65	\$ 253,564.65	2%
2	08/31/15	08/26/15	\$ 676,414.99	\$ 929,979.64	9%
3	09/30/15	09/29/15	\$ 457,238.16	\$ 1,387,217.80	13%

HVAC Construction – JBM Mechanical

Application #	Period Ending	Date Submitted	Net Amt for Payment	Cumulative Total	Total % Billed
1	07/31/15	07/31/15	\$ 47,250.00	\$ 47,250.00	2%
2	08/31/15	08/20/15	\$ 119,700.00	\$ 166,950.00	6%
3	09/30/15	09/25/15	\$ 143,523.00	\$ 310,473.00	12%

Electrical Construction – Albarell Electric

Application #	Period Ending	Date Submitted	Net Amt for Payment	Cumulative Total	Total % Billed
1	08/31/15	08/14/15	\$ 17,792.00	\$ 17,792.00	1%
2	09/30/15	09/17/15	\$ 18,995.76	\$ 36,787.76	2%

Plumbing Construction – DeWalt Plumbing

Application #	Period Ending	Date Submitted	Net Amt for Payment	Cumulative Total	Total % Billed
1	07/31/15		\$ 21,600.00	\$ 21,600.00	3%
2	08/31/15	08/21/15	\$ 72,450.00	\$ 94,050.00	11%
3	09/30/15	09/24/15	\$ 140,203.57	\$ 234,253.57	28%

Allowance Summary

General Construction – Lobar

PCO#	Description	Amount Submitted	Date Submitted	Status	AA#	Running Balance
1	Delete exterior courtyard benches per proposed change order GC-001	\$ 22,593.29	08/20/15	Approved	GC-001	\$ 194,943.29
2	Additional cost for sewer manhole drop at existing manhole per proposed change order GC-002.	\$ 5,638.33	09/01/15	Approved	GC-002	\$ 189,304.96
3	Additional cost for wireless gym scoreboard controller per proposed change order GC-003.	\$ 1,004.85	09/24/15	Approved	GC-003	\$ 188,300.11
4	Additional cost for removal and replacement of unsuitable soils with structural stone inside building pad per change order GC-004.	\$ 11,499.95	10/15/15	Approved	GC-004	\$ 176,800.16

HVAC Construction – JBM Mechanical

PCO#	Description	Amount Submitted	Date Submitted	Status	AA#	Running Balance
						\$ 121,000.00

Electrical Construction – Albarell Electric

PCO#	Description	Amount Submitted	Date Submitted	Status	AA#	Running Balance
EC-001	Change light fixture size in lobby.	\$ 2,311.00	09/21/15	Rejected		\$ 102,979.00
EC-002	Additional fire alarm devices	\$ 4,974.00	10/13/15	Pending		

Plumbing Construction – DeWalt Plumbing

PCO#	Description	Amount Submitted	Date Submitted	Status	AA#	Running Balance
1	Additional cost to install radon vent piping per change order PC-001	\$ 9,462.05	09/21/15	Approved	PC-001	\$ 30,662.95